



Yutong Bus Co., Ltd.

Yutong Marketing Center, Economic and Technological Development Zone, Zhengzhou, China Tel.: +86 371 6671 8999 Website: www.yutong.com
E-mail: sales@yutong.com

The images may include items of optional equipment and accessories that are not installed as standard. The product is subject to technical improvement.
Yutong reserves the right to change product specifications without prior notice. All rights reserved. March 2024 Edition.

C Series

NEW GENERATION COACH CHAMPION



DEPENDENTLY AND DURABLE SELECTED BY OVER 100,000 CUSTOMERS

Since the first generation of C series ZK6129H rolled out in 2004, the products have been sold all over the world. After years of market verification, the product performance has always been top-notch in the industry. Based on the constant pursuit of higher customer value, the R&D team has made continuous efforts to innovate and successively launched C series ZK6122H, 6128H and other best-selling models. At present, C series has traveled about 50 billion kilometers in the world, which is a further testimony of the reliability and durability.



2022
3rd Generation of C series family
ZK6128H

2014
2nd Generation of C series family
ZK6122H

2004
1st Generation of C series family
ZK6129H

EXCEED LIMITS RENEW FOR SUPERIOR UPGRADE

Yutong new generation C series products are not only the coach champions, but also the result of efforts made by Yutong's scientific research team and product R&D team. While inheriting the excellent genetic attributes of the previous family products, these products have improved in terms of **fuel efficiency** and **safety**, and achieved upgrades and breakthroughs in **driving experience** and **maintenance**, thus ensuring strong product strength.



More Reliable

It pioneers the use of vacuum filling process of brake fluid in the bus industry, significantly reducing pipeline air intake issues and effectively improving product reliability.



Safer

It is equipped with a number of active safety technologies such as driver fatigue warning and collision warning to improve the driving safety through intelligent technology.



More Fuel-efficient

It is equipped with two self-developed energy saving systems, i.e. the second-generation engine thermal management system and Blue Core intelligent fuel-saving system, and has achieved an average fuel consumption **better than that of its competitors** by more than **7%** when the A/C is off during driving and by more than 10% when the A/C is on during driving.



More Eye-catching

It features a streamlined overall design and smooth and modern appearance. Its front wall employs a continuous electroplated trim strip.



PINNACLE OF SAFETY AND RELIABILITY

The safety attributes of Yutong C series products are ensured through strict testing in multiple processes. The driving data of over one million kilometers has proved product safety and reliability. Some vehicles have a mileage of more than 1.59 million kilometers, with good vehicle conditions and no overhaul records. This once again proves the excellent quality genes of the family products.

High-strength Vehicle Body

The body frame features a robust closed structure made of high-strength steel (special for Yutong), **with yield ≥ 700 and tensile strength ≥ 980** . In case of vehicle rollover, the deformation of the body is small, so as to protect the safety of passengers in the vehicle to the greatest extent.

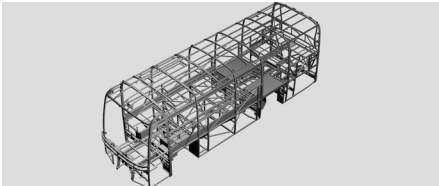

Vehicle electrophoresis without Corrosion for 10 Years

The implementation of full-immersion cathode electrocoating for the vehicle greatly improves its anti-corrosion ability and aesthetics. The electrophoretic coating is resistant to salt spray for **more than 1000 hours** and will not experience structural corrosion in 10 years.



The industry's 1st through-type energy-absorbing frontal collision safety structure

The bus structure is lengthwise divided into energy absorbing zone, rigid zone and deformation zone, which can absorb and disperse collision energy and force. Meanwhile, the driver seat adopts a backward movable structure. In case of collision, the driver seat will instantly move back by **80mm** with the frame to fully guarantee the safety of the driver and passengers.

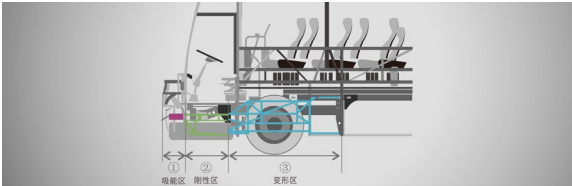

PINNACLE OF LUXURY AND COMFORT

Bring a pleasant driving and riding experience with technology, and combine the stability of large vehicles with the flexibility and comfort of small vehicles, so as to enable users to enjoy every journey to the fullest.



Enlarged Driver Cabin

The gearshift lever is optimized to be installed on the instrument panel. The front and rear space of the driver cabin is increased by more than 180 mm compared with the previous generation, which improves the convenience for the driver to enter and exit the driving area and increases the storage space in the driving area.

Super Comfortable Seats

The seats are adorned with high-quality leather interior trimming, thickened high-resilience memory foam and U-shaped semi-enclosed headrests to improve the riding comfort. Additionally, the seats are equipped with USB and power sockets to meet the charging needs of electronic equipment during the journey.



PINNACLE OF ECONOMY AND DURABILITY

Yutong always adheres to the concept of economical and practical development, and uses advanced technologies to realize lightweight vehicle body, intelligent fuel saving and enhanced luggage loading capacity, thereby achieving efficient mobility with excellent performance.

Ultra-low Fuel Consumption

Through the application of high-strength steel and optimization of vehicle body structure, new technologies such as lightweight technology, Blue Core second-generation intelligent fuel saving technology, electronic fan and A/C intelligent start/stop system are applied, and the comprehensive fuel consumption of the vehicle is reduced by about **10%**.

Super-large Luggage Compartment

The luggage compartment space is increased to **12.5 m³**, providing an extra **1 m³** of space compared with the previous generation, allowing for the loading of six additional 24-inch luggage cases.

Enhanced Air Suspension

The vehicle adopts large-diameter airbags of **325 mm**, and the rear axle is equipped with a long-span C-shaped bracket. Compared with traditional airbags and ordinary suspensions, it can greatly alleviate the impact of various complex road conditions on the vehicle body, so that the vehicle has greater bearing capacity while reducing the wear of suspensions and other related components.

Tests under Extreme Road Conditions

Tests under various extreme road conditions, such as high-speed loop test, wading test, highland test, severely cold test, high temperature test and comprehensive road test, have been conducted. This product can effortlessly navigate all challenges throughout the **50,000 m²** dynamic test track.

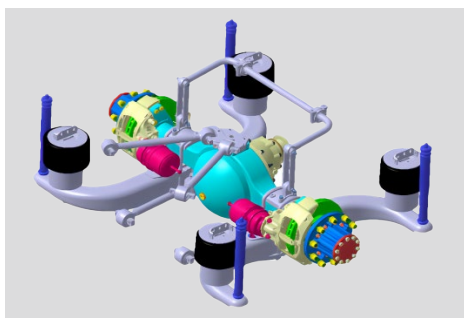



EFFICIENT AND COST-EFFECTIVE MAINTENANCE

Yutong C series boasts a stable vehicle architecture, a universal module structure, standard parts interfaces and a more reasonable vehicle layout, which makes the parts more versatile, reduces maintenance costs, and ensures that the products are safer, more reliable and of higher value.



Flip-up Front Wall and Rotating Electrical Parts

The middle skin of front wall can be moved upward and opened for easy access, so there is no need to remove the instrument panel during maintenance of defrosters and wipers. By rotating the electric box, electrical parts can be rotated to the outside of the compartment, which makes it more convenient to overhaul and replace electrical parts, thus greatly saving overhaul and maintenance time and reducing maintenance costs.



Front Axle with Integrated Maintenance-free Wheel End

The wheel hub bearing is of a high-precision bearing closed integrated structure, allowing for **5 years or 800,000 km** of maintenance-free operation. Taking a scenario of driving **1 million km in 5 years** as an example, compared with ordinary wheel-end axles, using maintenance-free bearing unit structure can save about RMB **100,000** in costs (including the value created during maintenance) over the full life cycle.



Centralized Inspection Connector Design

Through the centralized inspection connector of the braking system, various fault points of the brake pipeline can be quickly troubleshooted to save maintenance time.

Quality Service Worry-free After-sales Service

Yutong has been always refining its service models, improving its service capabilities, and building a professional integrated service platform, so as to provide customers with more convenient and efficient high-quality service experience and meet diversified service needs.

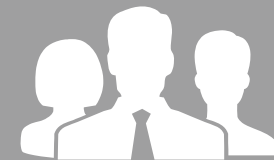

FULL-TIME NEW ENERGY SERVICE TEAM:

a butler-style personal service team, addressing all doubts and providing maintenance solutions across all aspects, realizing real one-stop service.



7*24H BUTLER SERVICE:

delivery - registration - operation,
7*24h all-round butler service.



SERVICE + TRAINING:

hierarchical, classified and targeted free training for customers' drivers and management personnel, and training support throughout the full life cycle.



NEARBY STATIONING POINT, QUICK RESPONSE:

stationed near the customer's company or main operating routes to ensure quick response.



BACKGROUND MONITORING, PROACTIVE INTERVENTION:

self-owned safety monitoring system, allowing for real-time monitoring of vehicle operation and proactive and immediate intervention in case of any problem.



CUSTOMIZED SERVICE PACKAGE:

customized services, vehicle safety inspections, energy-saving driving competitions, maintenance technician skills competitions, and other service activities.

GLOBAL SERVICE CASES



Kazakhstan Output of Excellent Products and Advanced Technologies

Yutong has entered the Kazakhstan market for more than 16 years, with 3,388 large and medium-sized buses in operation, making it the largest bus brand in Kazakhstan. The mass launch of Yutong new energy buses, especially battery electric vehicles, has accelerated the upgrading of local green transportation.



In 2021, the KD plant jointly built by Yutong and a Kazakhstan technology company was officially put into operation, exporting Yutong Bus technology, supply chain service capabilities, business models and standards locally, helping to promote the development of the local automobile industry.



In 2023, Yutong carried out a battery electric vehicle extreme challenge locally. The vehicle under test was a battery electric bus that had been in operation for 3 years. It can still run 320 km in the extreme environment of -27°C with a rated driving range of 350 km, demonstrating excellent driving range performance.

With Yutong's Support, Karaganda No. 3 Bus Group in Kazakhstan Has Realized Safe Driving for 1.59 Million km without Major Repairs



Since 2013, Karaganda No. 3 Bus Group has successively purchased more than 200 Yutong buses to serve the bus and coach lines in neighboring cities of Karaganda for a long time, with an average monthly travel distance of about 15,000 km per bus. During this period, these buses are in good condition without major repairs. In view of the excellent quality performance of Yutong buses, Karaganda No. 3 Bus Company purchased another batch of 50 Yutong buses (ZK6118HGA) in 2022.



Yutong buses can safely run 1.59 million km without major repairs, which greatly reduces the purchase cost for customers switching to new vehicles after 600,000 km with other lower-end brands. The service cycle is longer, and the costs for daily maintenance and replacement of contacts for the vehicle body, chassis, engine and electrical parts are lower, bringing higher economic efficiency to users. In addition, Yutong buses fully consider the full value needs of customers for safety, reliability, comfort, durability and health, providing not only worry-free services throughout the cycle, but also high-yield operational guarantee.



Saudi Arabia Offering High-end and Comfortable Travel Experience

Yutong buses are very popular in Saudi Arabia, featuring strong power, large capacity, thermal management technology and comfortable experience. In Saudi Arabian Public Transportation Company, there are more than 800 units of this model, representing more than two-thirds of the total vehicles in the company's fleet.



The United Kingdom The Choice of High-end and Comfortable Riding Experience

As the birthplace of the global automobile industry, the United Kingdom has stringent requirements for the performance of automobile products and attaches great importance to user-friendly riding experience. Yutong has ingeniously developed the high-end E series bus and T series tourism coach products to meet the high-standard product requirements of the European market. With high comfort, quietness, ergonomics and luxury modeling design, Yutong products have gained the trust of more than 200 tourism bus operators in the United Kingdom. The eco-friendliness of new energy buses has led more than 100 cities and towns to choose Yutong's battery electric buses. By 2022, Yutong has sold over 900 units in the United Kingdom, representing a remarkable growth rate of 51.4% compared with the data in 2021.



GLOBAL SERVICE CASES

Qatar A Facilitator of Customized Public Transport Solutions

During the FIFA World Cup Qatar 2022™, Yutong specially designed a comprehensive battery electric product solution of "trunk line bus + feeder line micro-circulation link-up bus + long-driving range coach" for Qatar. This solution has solved the problems related to high-end reception, trunk line transportation and urban last-mile mobility, and ensured the safe and efficient operation of vehicles during the top football events in Qatar.

Service Guarantee Achievements during FIFA World Cup Qatar 2022™



Professional services:
126 Yutong service support personnel



24h operation:
1500 Yutong buses (including 888 battery electric buses), providing all-weather transportation services



Outstanding mileage:
over 2.6 million passengers transported and over 3 million km traveled



Low carbon and environmental protection:
helping to reduce local carbon emissions by more than 3.3 million kg

France Recognition by Five Major Operators

Yutong has become the largest Chinese bus brand in France, with a cumulative sales volume of more than 700 units in the local market. In 2019, Provence launched the first battery electric intercity bus line in Europe, and Yutong ICe12 served this line. Yutong's unique battery electric intercity bus has solved the problem of electrification for long-distance public transportation between small towns in France. After years of cooperation, it has been recognized by global operators such as RATP, TRANSTEV and Keolis.



Norway Battery Electric Bus without Fear of Extreme Cold

The comprehensive performance of Yutong's battery electric products has surpassed that of similar products from top European brands. In actual operation, Yutong's battery electric products show excellent performance of battery life and driving range attenuation in winter, with a power consumption of as low as 1.0 kW · h per kilometer, and have gained market recognition and good product reputation. At present, a total of 224 Yutong battery electric vehicles have been operated in Norway, providing better green mobility services for Norway and helping to achieve its goal of carbon reduction.



PRODUCT PARAMETERS AND CONFIGURATION TABLE

C9 6907H

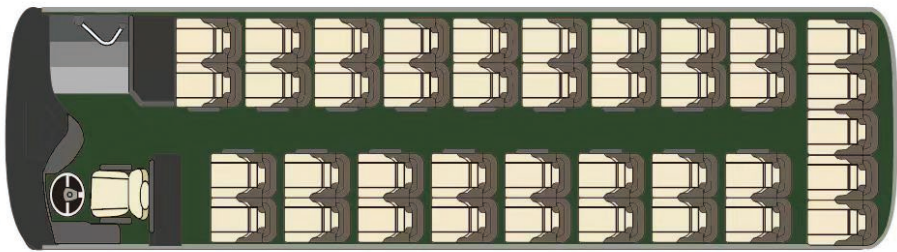

C9 39+1+1



| Configuration: | |
|---------------------------|---------------------------|
| Overall L * W * H (mm) | 8970*2550*3450 |
| Engine | Cummins C230-20 |
| Displacement (L) | 8.3 |
| Emissions | Euro II |
| Transmission | FAST 6DS-130 transmission |
| Clutch | SACHS push-type clutch |
| Front axle | YUTONG,DiscBrake,4.5T |
| Rear axle | YUTONG,DiscBrake,9T |
| Tire | 10R22.5 |
| Suspension system | Leaf spring suspension |
| A/C | Cling A/C (24000 kcal/h) |
| Fuel tank volume (L) | 260 |
| Seating capacity | 39+1+1 |

C11 6117H

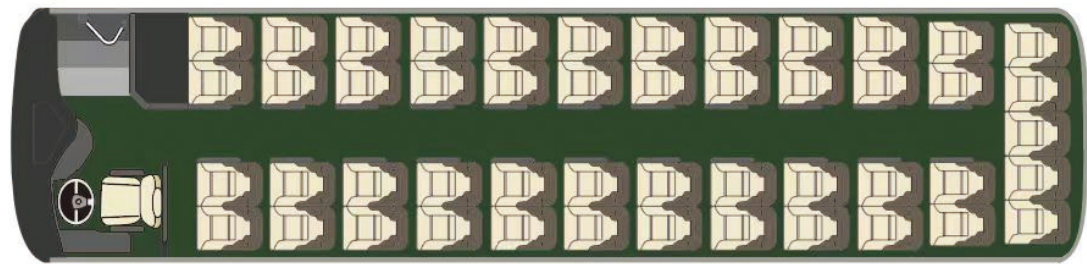

C11 49+1+1



| | |
|---------------------------|--|
| Configuration: | |
| Overall L * W * H (mm) | 10990*2550*3640 |
| Engine | YUCHAIYC6L310-50 |
| Displacement (L) | 8.424 |
| Emissions | EUROV |
| Transmission | FAST 6DSX100T |
| Clutch | SACHS clutch |
| Front axle | YUTONG |
| Rear axle | YUTONG |
| Tire | 11R22.5 |
| Suspension system | Air spring suspension |
| A/C | Yutong Bus roof-mounted A/C (28,000 kcal/h), Bock compressor |
| Fuel tank volume (L) | 260 |
| Seating capacity | 49+1+1 |

C12PRO 6128H

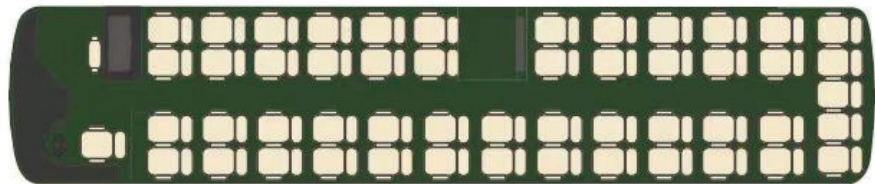

C12PRO 51+1+1

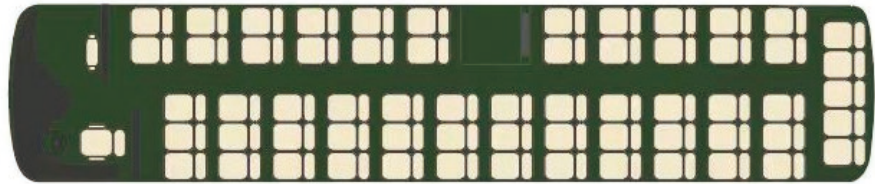

C12PRO 63+1+1



| Configuration: | |
|---------------------------|--|
| Overall L * W * H (mm) | 12000*2550*3860 |
| Engine | WD615.44/WD615.46 |
| Displacement (L) | 9.726 |
| Emissions | Euro II |
| Transmission | FAST 6DSX150TC |
| Clutch | SACHS pull-type clutch |
| Front axle | Molead disc-type 7.5T |
| Rear axle | MOLEAD disc-type 13T |
| Tire | Michelin/Goodyear |
| Suspension system | Leaf spring suspension/Air spring suspension |
| A/C | Cling A/C (cooling capacity 32000 kcal/h, Bock compressor) |
| Fuel tank volume (L) | 600/1000 |
| Seating capacity | 51+1+1/63+1+1 |

C13PRO 6138H

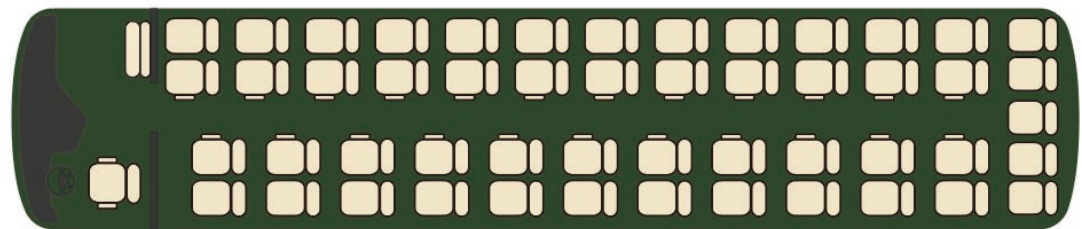

C13 51+1+1



| Configuration: | |
|---------------------------|--|
| Overall L * W * H (mm) | 12500*2550*3840 |
| Engine | WP10.375 |
| Displacement (L) | 9.726 |
| Emissions | Euro III |
| Transmission | ZF6S1610BO |
| Clutch | SACHS pull-type clutch |
| Front axle | Molead |
| Rear axle | Molead |
| Tire | Michelin 295/80R22.5 |
| Suspension system | Air spring suspension |
| A/C | Cling A/C (cooling capacity 32000 kcal/h, Bock compressor) |
| Fuel tank volume (L) | 600 |
| Seating capacity | 51 (51 passenger seats)/53 (with tour guide and driver) |